

Balfit® SAE 37° Flared Pipe Fittings

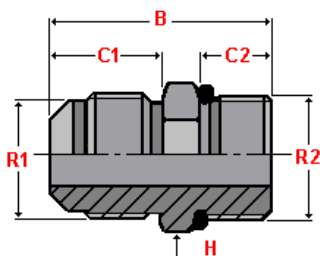

Balfit® JIC x BSPP Male Connector – 35.230.

carbon steel JIC x BSP male connector parallel thread



According to **ISO 8434-2** According to **SAE J514**

Material: Carbon Steel

Finish: Zinc-plated

part number	∅ tube		thread		dimensions				working pressure bar
	mm	inch		R2	B	C1	C2	H	
35.230.0402	6	1/4"	7/16" – 20	1/8" – 28	29	14	6	16	345
35.230.0404		1/4"	7/16" – 20	1/4" – 19	32	14	10	19	345
35.230.0504	8	5/16"	1/2" – 20	1/4" – 19	32	14	10	19	345
35.230.0506	8	5/16"	1/2" – 20	3/8" – 19	33	14	10	22	345
35.230.0604	10	3/8"	9/16" – 18	1/4" – 19	32	14	10	19	345
35.230.0606	10	3/8"	9/16" – 18	3/8" – 19	33	14	10	22	345
35.230.0608	10	3/8"	9/16" – 18	1/2" – 14	39	14	13	30	310
35.230.0806	12	1/2"	3/4" – 16	3/8" – 19	36	17		22	310
35.230.0808	12	1/2"	3/4" – 16	1/2" – 14	41	17	13	30	310
35.230.1006	14	5/8"	7/8" – 14	3/8" – 19		19	10	24	240
35.230.1008	15	5/8"	7/8" – 14	1/2" – 14	44	19	13	30	240
35.230.1012	16	5/8"		3/4" – 14	44	19	13	36	240
35.230.1208	20	3/4"	1.1/16" – 12	1/2" – 14	47	22	13	30	240
35.230.1212	20	3/4"	1.1/16" – 12	3/4" – 14	48	22	13	36	240
35.230.1616	25	1"	1.5/16" – 12	1" – 11	54	23	16	46	210
35.230.2020	32	1.1/4"		1.1/4" – 11	57	24	16	50	170
35.230.2424	38	1.1/2"	1.7/8" – 12	1.1/2" – 11	61	28	16	60	140

also available:

Balfit® Stainless Steel Straight JIC x BSPP Male Connector

(add an 'S' at the end of the part number; ex: 35.230.0808 S)

Construction characteristics and dimensions may be changed at any time without prior notice.

The data contained herein is information purposes only and does not enlarge, amend or imply any warranty other than provided by the manufacturer with the product. Any use of the product not in conformance with the manufacturer's instructions may be dangerous.

Only items in this catalogue are carried in stock. Some items are subjected to minimum quantities or sold only in multiples of standard quantities. Please refer to the price list or contact our commercial department.

Balflex® – The European Technology